



Dear PA Museums Conference Attendee:

Enclosed is a package of information to help you prepare for your upcoming visit to the Penn State All-Sports Museum.

Your tour is scheduled for **Sunday, April 15, 2018** at **2pm**. Your docents for that day will be **Sandy** and **Gary**. Please note that **all** of our volunteers and staff have had background checks and mandatory reporter training.

If there are any changes, particularly to the size of the group (if larger than anticipated), please contact the museum as soon as possible.

Enclosed you will find a map of where vehicles/busses are able to park, a layout map of the sports located throughout the museum, and a document on visitor etiquette. Please look over the enclosed information to help prepare your group for their upcoming visit. By opening this email attachment, you are agreeing to the etiquette terms cited in this document.

We look forward to your visit to the Penn State All-Sports Museum, and hope you enjoy your time with us!

Sincerely,

A handwritten signature in black ink that reads "Aimee Brown-Shadduck".

Aimee Brown-Shadduck | Programming and Education Coordinator
Penn State All-Sports Museum | 1 Beaver Stadium | University Park, PA 16802
Office: (814) 863-5689 | Fax: (814) 865-6677 | gopsusports.com/museum
[Join Us](#) | [Facebook](#) | [Twitter](#) | [Instagram](#) | [Pinterest](#) | [PSUMuseums](#)

All-Sports Museum Visitor Etiquette

TOURS:

- Please be on time for your scheduled tours. **Guided tours that are more than 20 minutes late will be cancelled.** Please call the museum's main number (814-865-0044) if you will be late.
- Food, drinks, gum, cell phones, and pets are not permitted in the galleries of the museum.
- The possession or use of alcohol and other drugs, fireworks, guns and other weapons is prohibited.
- No violence, including sexual abuse or harassment, will be tolerated.
- Hazing of any kind is prohibited. Bullying including verbal, physical, and cyber bullying are prohibited.
- No theft or use of tobacco products (smoking is prohibited in **all** University buildings) will be tolerated.
- Misuse or damage of University property is prohibited. Charges will be assessed against those participants who are responsible for damage or misusing University property.
- The inappropriate use of cameras, imaging, and digital devices is prohibited including use of such devices in showers, restrooms, or other areas where privacy is expected by participants.
- Large coats and bags should be left on the coat racks at the entrance of the museum. (This excludes those needing to carry medication or other necessary items.)
- Still photographs are permitted in the museum and the stadium. Video is **not** permitted.
- Stadium views and gift shop visits are done after a tour of the gallery spaces.
- Please have your groups divided before you arrive to the museum.
- Excessive noise, running, pushing, shoving, or other physical acts are disruptive to other visitors, endanger the artifacts that are on display, and will result in dismissal from the museum.
- **Chaperones are expected supervise and discipline groups at all times.**

STADIUM VIEWS:

- Stadium views may not be available at certain times of the year (i.e. on game day, or if there is an event in the stadium). We appreciate your patience and understanding.
- **Stadium views are 100% weather dependent.**
- One adult must be present per elevator when going up to see the stadium.
- Once in the stadium, if an individual or group wanders beyond where they are told, this is grounds for immediate dismissal from the stadium and museum. We hold the right to contact Penn State University Police if necessary.
- Shouting or engaging with anyone who is on the field during a stadium view will immediately end the view.

GIFT SHOP:

- Please allow sufficient time for your group to check out.
- Chaperones are expected to help students/visitors shop to find items that fit with the amount of money that they brought; it is not the responsibility of the gift shop staff.

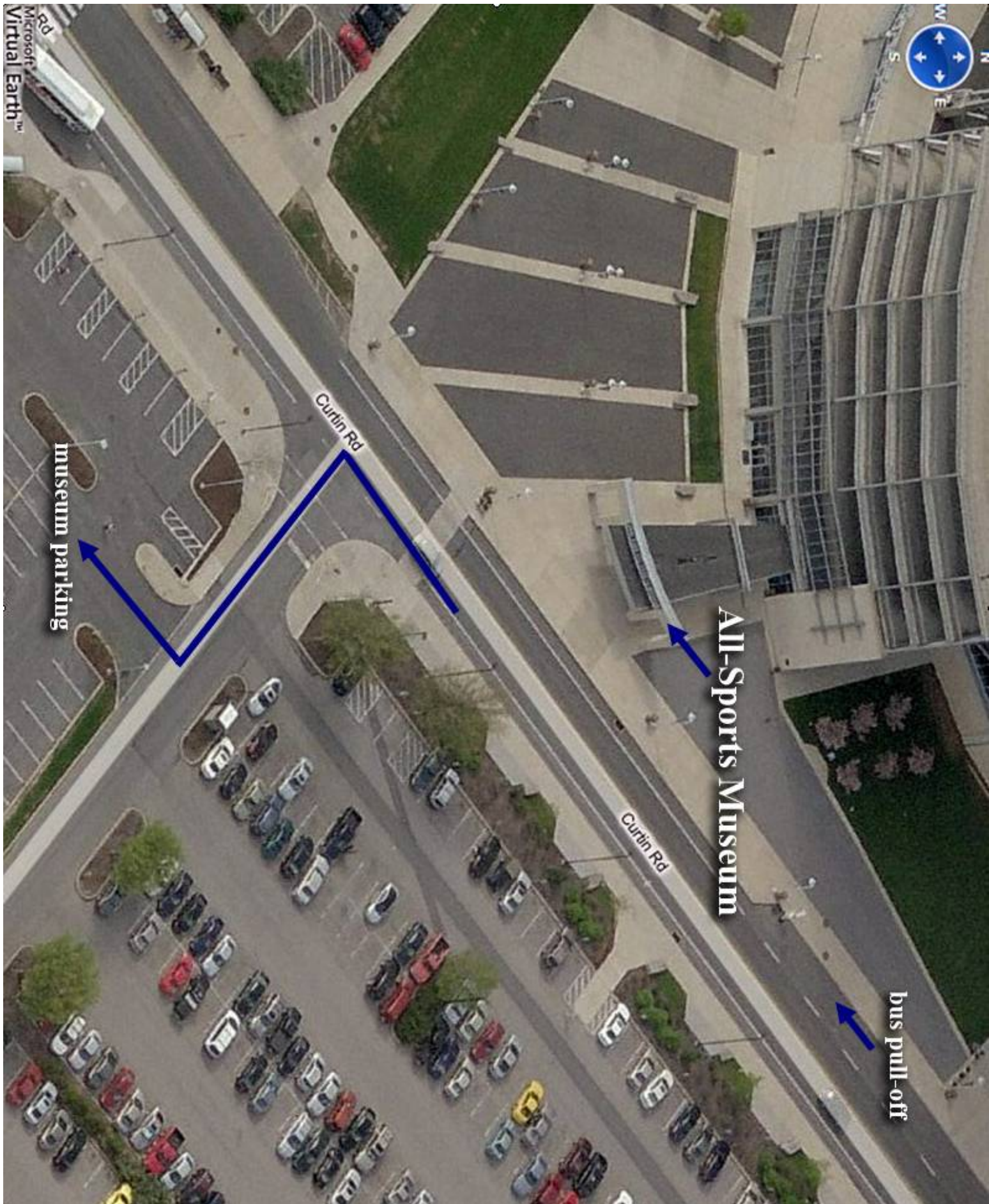

Microsoft
Virtual Earth™



museum parking

All-Sports Museum

bus pull-off

Curtin Rd

Curtin Rd

Penn State All-Sports Museum

Floor Map

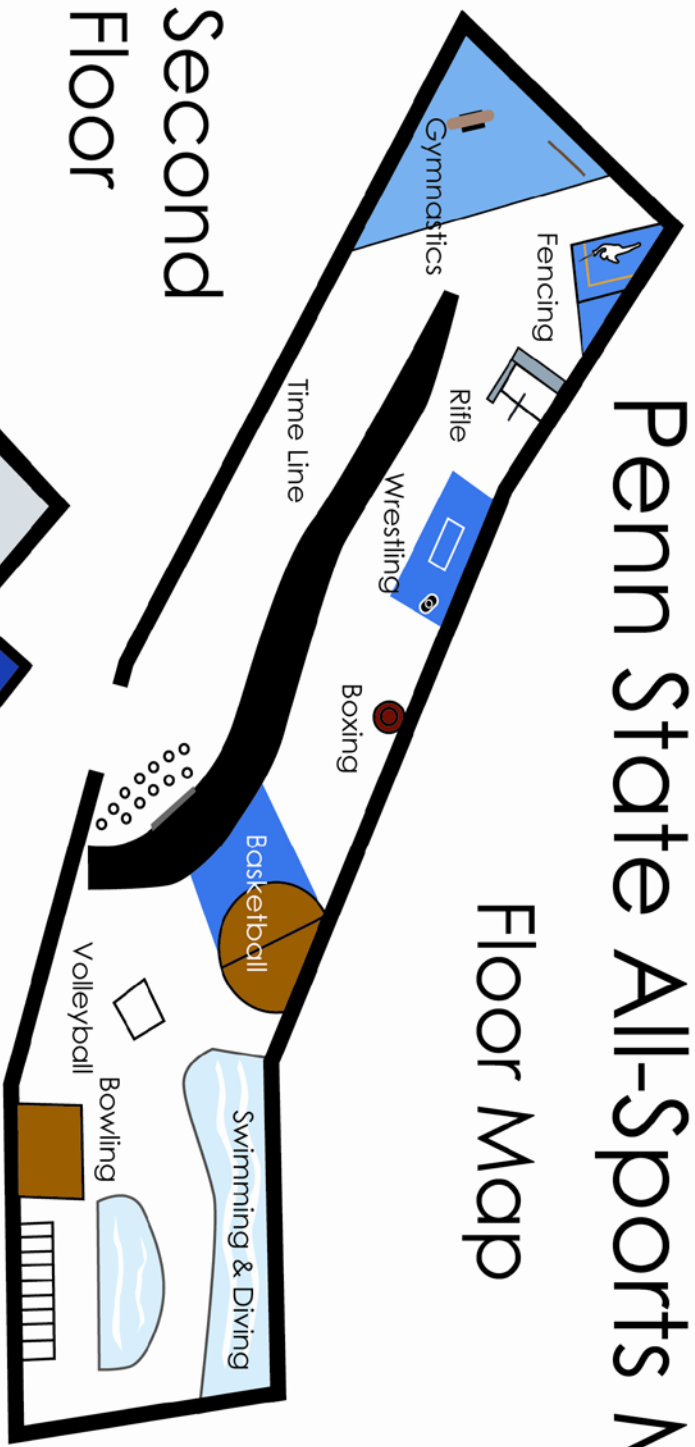

Second Floor

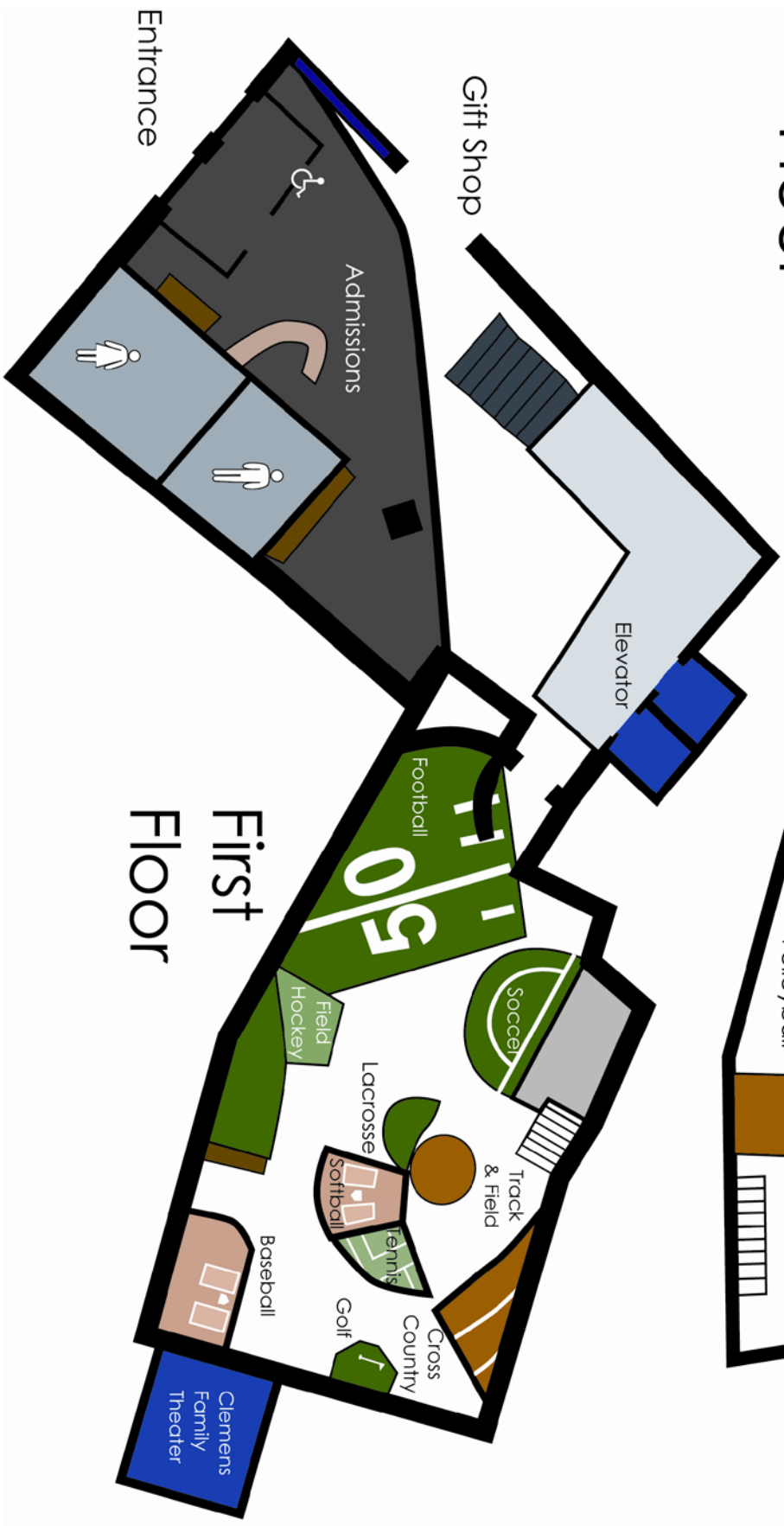

First Floor